

Punch with heel or heeled punch tool

Avoid punch and die jamming when punching one side load.

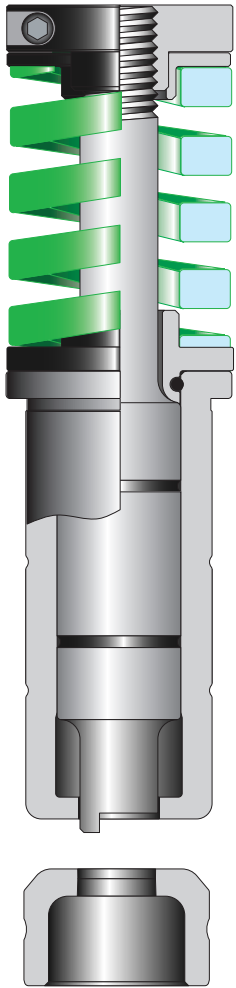

When punch the side edge of pre-sheared material sometimes we got punch and die jamming problem. This tool is designed to avoid such jamming problem. The heel portion gets into die first, then actual punch area works on the material. The heel portion gets side load and protects from jamming. When punch thick material side load will be larger, his heel works effectively.

Heel area is not working for actual punching, this works only for side load protection purpose. When punch thick material side load will be large, this heel works effectively.

No jamming !
 Safety punch



Typical heeled tool design

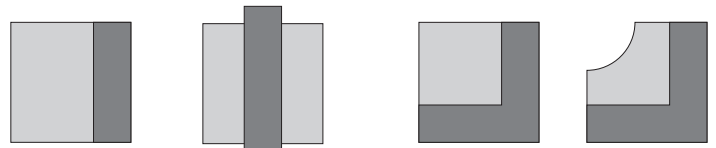

Edge cutting

Corner knocking

Standard punch (Jamming)

Heeled punch

Heel area is getting into die before punching

